

Can hens teach one another?



Introduction

The domesticated phenotype includes changes in the size of a number of brain areas. Possibly, a shift in cognitive function occurred as domestic chickens (here, White Leghorn layers, WLs) separated from Red Junglefowl (RJF).

The goal of this experiment was to assess whether RJF and WLs are able to learn a puzzle-opening task from a demonstrating conspecific and determine if notable differences in social learning exist between the two subspecies.

Methods

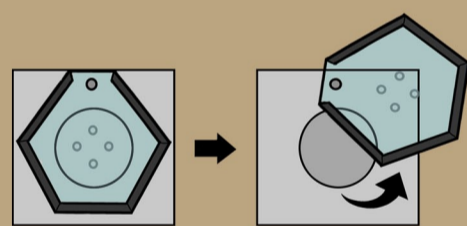

Two pre-trained birds demonstrated how to push away a lid from a puzzle apparatus to receive food. Guided observers were given the same task after 5 demonstrations, while naïve ones had no demonstrations.

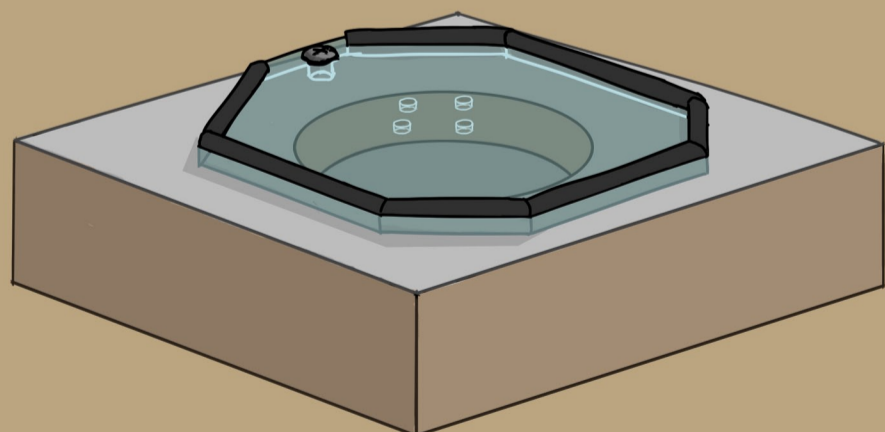

Females of both subspecies learn from observing a conspecific, and Red Junglefowl are more efficient than White Leghorns.

Results

How far did the birds push open the lid?

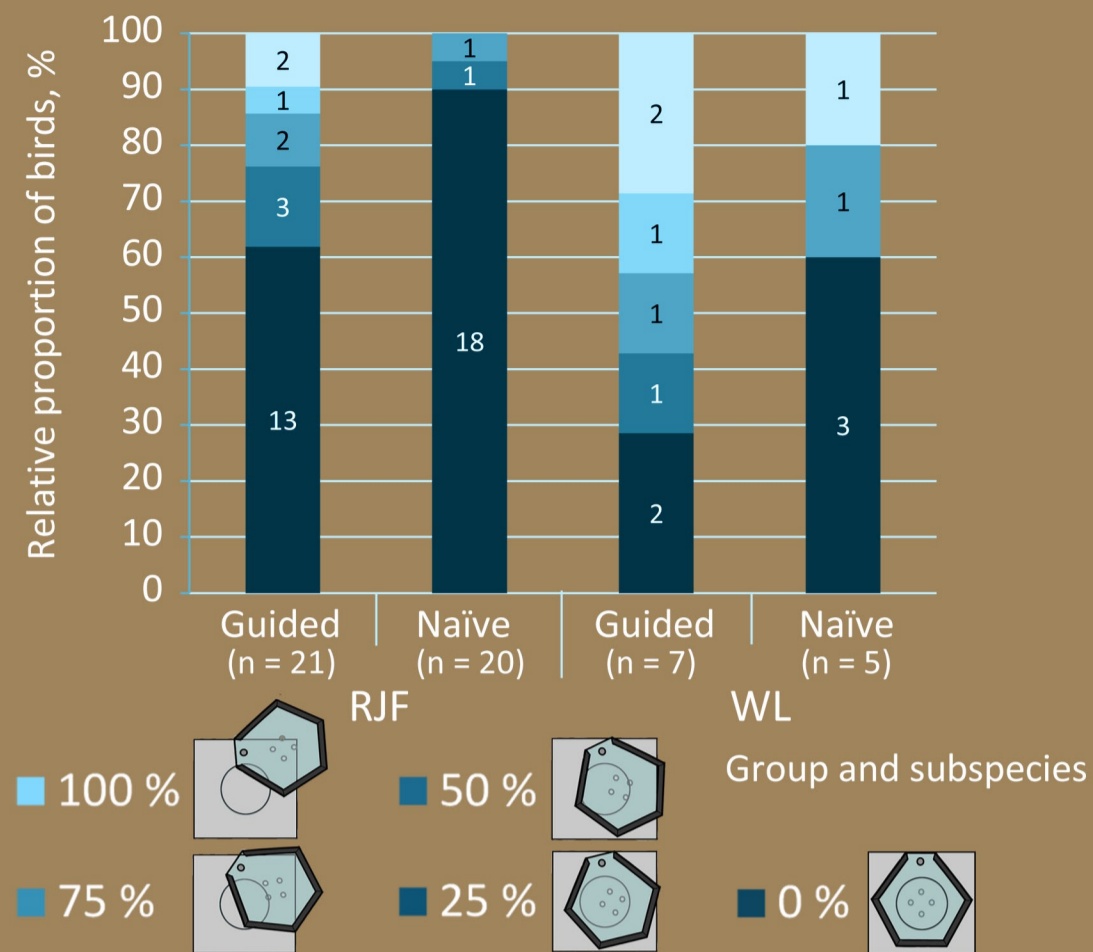

Time spent interacting with puzzle apparatus

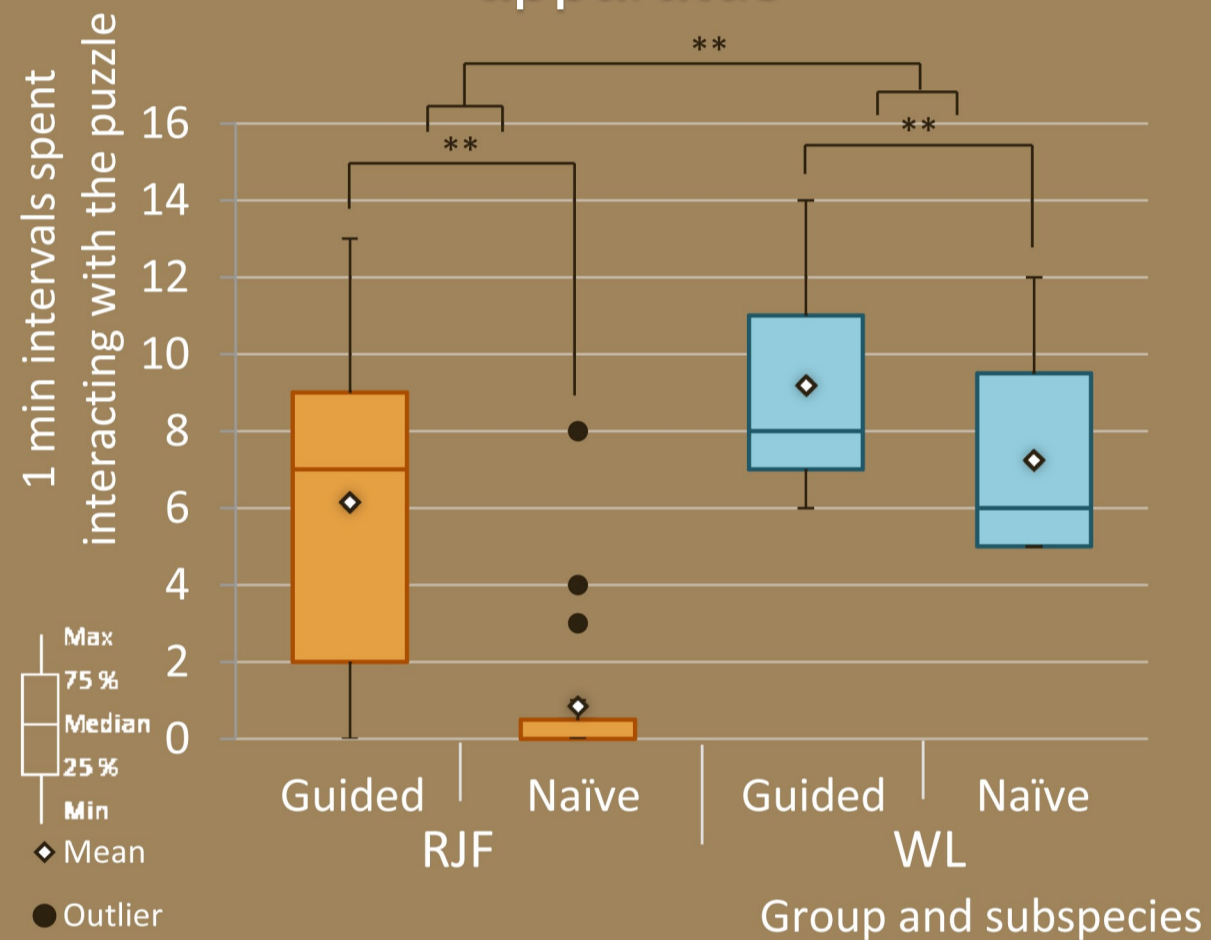

Pecks directed at puzzle apparatus

